



## TRAYSLIDES: G-SERIES 1-SECTION HEATED CABINET

Parts	Universals		#1 Trayslides		#4 Trayslides	
Kit Model	G1ACC-TK4		G1ACC-TK1		G1ACC-TK2	
	Model #	QTY	Model #	QTY	Model #	QTY
Pilasters: Front Left, Back Right	342-60169-01	2	342-60169-01	2	342-60169-01	2
	342-60169-02	2	342-60169-02	2	342-60169-02	2
Pilasters: Front Right, Back Left	342-60170-01	2	342-60170-01	2	342-60170-01	2
	342-60170-02	2	342-60170-02	2	342-60170-02	2
Thumb Screws	351-15822-01	24	351-15822-01	24	351-15822-01	24
Trayslide Inserts	701-60039-00	14	701-60032-00	16	340-04842-00	4

### RECOMMENDED TOOLS:

Flathead Screwdriver, Rubber Mallet and Phillips Head Screwdriver (Optional).

## INSTALL UNIVERSALS

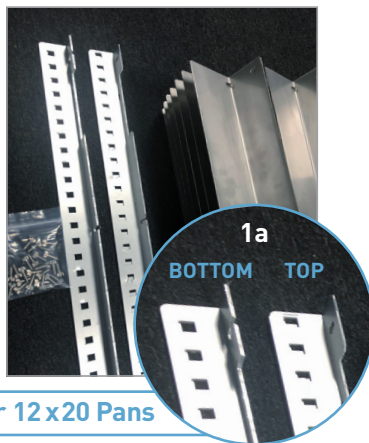

Bottom Support 18x26 or 12x20 Pans

**KIT:** G1ACC-TK4 | **TRAYSLIDE PART:** 701-60039-00

- (Fig. 1a) Identify the top side of each Pilaster.**
- Remove the factory installed shelves, pins, and pilasters.**
- (Fig. 3a-3b) Install the back left and front right pair/set Pilasters with 3 thumb screws each.**
  - Hand tighten the thumb screws, check that the Pilasters are parallel with the sides of the cabinet, and then tighten down with a flathead screwdriver.
  - If you cannot get to the screws with a screwdriver you will need to remove the heating element on the side of the cabinet with a Phillips Head screwdriver to tighten the thumb screws.
- Repeat step 2 with the back right and front left Pilasters.**

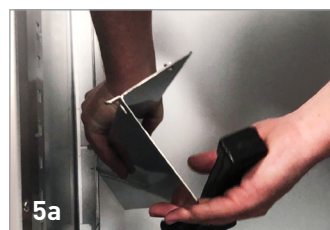

- If the heating element was removed, re-install the heating element back into its original position before installing the Trayslides.

### 5. (Fig. 5a-5b) Begin installing the Trayslides on one side from bottom to top.

- Insert the bottom set of tabs into the slots at desired height.
- On one side, insert the top tab into the Pilaster slot, and tap the top of the Trayslide near that Pilaster with a rubber mallet.
- Repeat on the other side of the Trayslide while being careful not to unseat the side that was installed first.
- Once both ends are seated in the Pilaster slots, tap the top of the Trayslide with a rubber mallet near both Pilasters to secure it.

### 6. Repeat step 5 on the other side of the cabinet.

- Be sure to check that the Trayslides match up with the ones installed on the other side.

### 7. Test on the top set, middle set, and bottom set of Trayslides to make sure that the Pilasters and Trayslides have been installed level.

## INSTALL #1 TRAYSLIDES



**Bottom Support of 18x26 Sheet Pans**

**KIT: G1ACC-TK1 | TRAYSLIDE PART: 701-60032-00**

- (Fig. 1a) Identify the top side of each Pilaster.**
- Remove the factory installed shelves, pins, and pilasters.**
- (Fig. 3a-3b) Install the back left and front right pair/set Pilasters with 3 thumb screws each.**
  - Hand tighten the thumb screws, check that the Pilasters are parallel with the sides of the cabinet, and then tighten down with a flathead screwdriver.
  - If you cannot get to the screws with a screwdriver you will need to remove the heating element on the side of the cabinet with a Phillips Head screwdriver to tighten the thumb screws.
- Repeat step 2 with the back right and front left pair/set Pilasters.**

[CLICK HERE TO WATCH #1 HOW-TO VIDEO](#)

## INSTALL #4 TRAYSLIDES

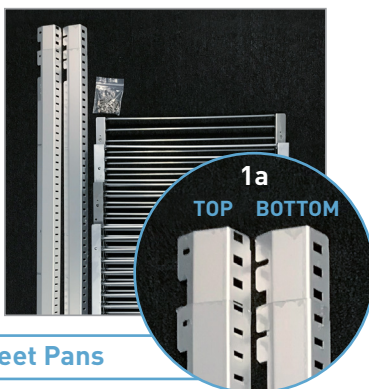

**Lip Support of 18x26 Sheet Pans**

**KIT: G1ACC-TK2 | TRAYSLIDE PART: 340-04842-00**

- (Fig. 1a) Identify the top side of each Pilaster.**
- Remove the factory installed shelves, pins, and pilasters.**
- (Fig. 3a-3b) Install the back left and front right pair/set Pilasters with 3 thumb screws each.**
  - Hand tighten the thumb screws, check that the Pilasters are parallel with the sides of the cabinet, and then tighten down with a flathead screwdriver.
  - If you cannot get to the screws with a screwdriver you will need to remove the heating element on the side of the cabinet with a Phillips Head screwdriver to tighten the thumb screws.
- Repeat step 2 with the back right and front left pair/set Pilasters.**

[CLICK HERE TO WATCH #4 HOW-TO VIDEO](#)

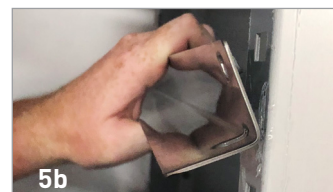
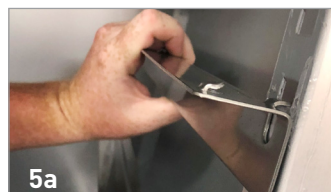
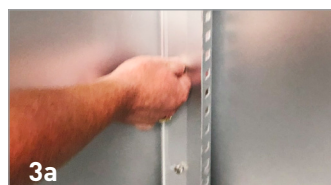

- If the heating element was removed, re-install the heating element back into its original position before installing the Trayslides.

**5. (Fig. 5a-5b) Begin installing the Trayslides on one side from bottom to top.**

- Insert the bottom set of tabs into the slots at desired height.
- On one side, insert the top tab into the Pilaster slot, and tap the top of the Trayslide near that Pilaster with a rubber mallet.
- Repeat on the other side of the Trayslide while being careful not to unseat the side that was installed first.
- Once both ends are seated in the Pilaster slots, tap the top of the Trayslide with a rubber mallet near both Pilasters to secure it.

**6. Repeat step 5 on the other side of the cabinet.**

- Be sure to check that the Trayslides match up with the ones installed on the other side.

**7. Test on the top set, middle set, and bottom set of Trayslides to make sure that the Pilasters and Trayslides have been installed level.**

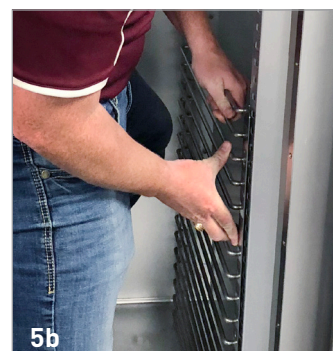
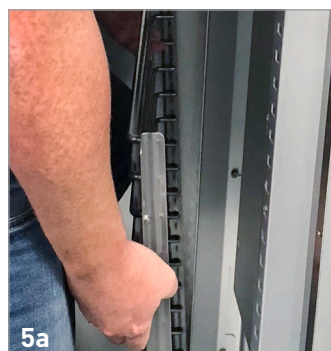

- If the heating element was removed, re-install the heating element back into its original position before installing the Trayslides.

**5. (Fig. 5a-5b) Begin installing the Trayslides on one side from bottom to top.**

- Insert the bottom set of tabs into the slots at desired height.
- On one side, insert the top tab into the Pilaster slot, and tap the top of the Trayslide near that Pilaster with a rubber mallet.
- Repeat on the other side of the Trayslide while being careful not to unseat the side that was installed first.
- Once both ends are seated in the Pilaster slots, tap the top of the Trayslide with a rubber mallet near both Pilasters to secure it.

**6. Repeat step 5 on the other side of the cabinet.**

- Be sure to check that the Trayslides match up with the ones installed on the other side.

**7. Test on the top set, middle set, and bottom set of Trayslides to make sure that the Pilasters and Trayslides have been installed level.**