



Project \_\_\_\_\_  
AIA # \_\_\_\_\_ SIS # \_\_\_\_\_  
Item # \_\_\_\_\_ Quantity \_\_\_\_\_ C.S.I. Section 114000

## TE Series

Freezer Equipment Stands  
Self-Contained  
Two Drawer Models



### STANDARD PRODUCT FEATURES

- Stainless Steel Exterior & Interior
- Galvanized Steel Exterior Back & Bottom
- Stainless Steel Top w/Drip Guard (Marine) Edge
- Reliable Microprocessor Control With LED Temperature Display
- Balanced, Self-Contained Refrigeration System Using R-448A
- Front-Breathing Design for "Zero-Clearance" Installation
- Non-Electric Automatic Condensate Evaporator
- Condenser Filter (protects coil)
- Hot Gas Defrost
- Controllable Anti-Condensate Drawer Perimeter Heaters
- Full Length Drawer Handle with Gasket Guard
- Magnetic Snap-In Drawer Gaskets
- Easily Removable Drawers Accomodate 12" x 20" x 6" Pans (pans by others)
- Self-Closing Drawers with Stay-Open Feature
- Heavy Gauge Stainless Steel Drawer Slides
- Side, Front & Rear Access Panel for Ease of Service & Maintenance
- NEMA 5-15P Plug with 9' Cord & Cord Retainer
- Set of Four (4) 4" Casters on Adjustable Caster System
- Three (3) Year Parts and Labor Warranty
- Five (5) Year Compressor Parts Warranty



This unit is listed to the applicable UL, CSA and NSF Standards by an approved NRTL.  
Consult the factory or units data plate for approval information.

### ACCESSORIES & OPTIONS

- Set of 6" High Stainless Steel Legs in Lieu of Casters
- 6" Cabinet Length Extension
- Stainless Steel Exterior Finished Back

### AVAILABLE CONFIGURATIONS

Two or Four Drawer Models, 34" Deep

#### Model

TE048LT  
TE060LT

#### Model Type

48" 2-Drawer Model  
60" 2-Drawer Model

Approved by \_\_\_\_\_ Date \_\_\_\_\_ Approved by \_\_\_\_\_ Date \_\_\_\_\_



# TE Series

Freezer Equipment Stands  
Self-Contained

## MODELS

Two Drawer Models: TE048LT, TE060LT

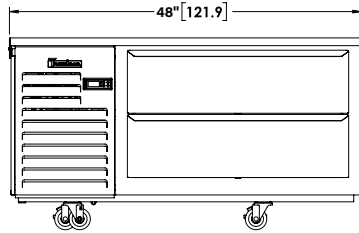
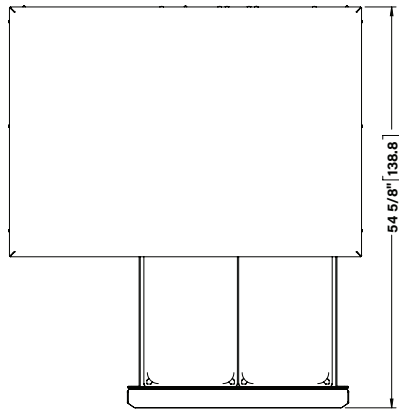

Elevation - TE048LT

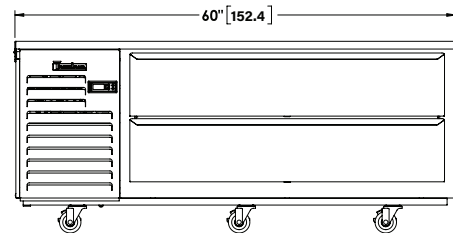
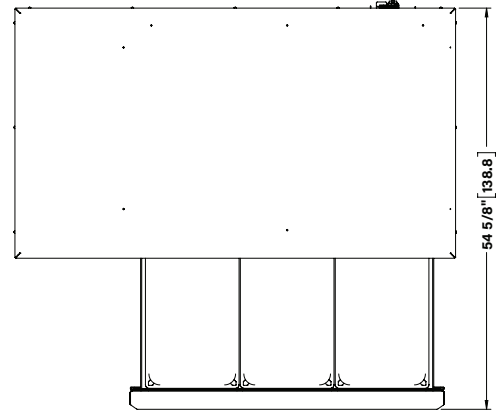

Elevation - TE060LT

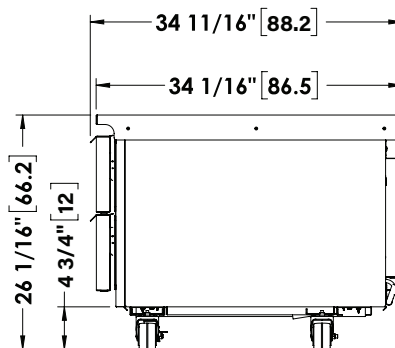

Section View - All Models



## MODELS

TE048LT, TE060LT

| MODELS  | TE048LT            | TE060LT            |
|---|--------------------|--------------------|
| <b>CABINET DIMENSIONAL DATA</b>                 |                    |                    |
| Length - Overall in.                            | 48 (121.9 cm)      | 60 (152.5 cm)      |
| Depth - Cabinet Only in.                        | 32 (81.3 cm)       | 32 (81.3 cm)       |
| Depth - Drawer Open in.                         | 54 5/8 (138.8 cm)  | 54 5/8 (138.8 cm)  |
| Depth - Over Handle in.                         | 34 11/16 (88.1 cm) | 34 11/16 (88.1 cm) |
| Height - Overall on 4" Casters <sup>1</sup> in. | 26 1/16 (66.2 cm)  | 26 1/16 (66.2 cm)  |
| Max Top Load Capacity lbs.                      | 625 (283 kg)       | 1200 (544 kg)      |
| Pan Capacity - 12" x 20" x 6"                   | 4                  | 6                  |
| Pan Orientation                                 | Side by Side       | Side by Side       |
| Drawers Per Cabinet                             | 2                  | 2                  |
| <b>ELECTRICAL DATA</b>                          |                    |                    |
| Voltage   | 115/60/1           | 115/60/1           |
| Plug  | NEMA 5-15P         | NEMA 5-15P         |
| Full Load Amperes                               | 8.2                | 8.7                |
| MDEC <sup>2</sup>                               | N/A                | N/A                |
| <b>REFRIGERATION DATA</b>                       |                    |                    |
| Refrigerant                                     | R-448A             | R-448A             |
| Refrigerant Amount oz.                          | 16 (453.6 gr)      | 20 (567 gr)        |
| BTU/HR   HP <sup>3</sup>                        | 1929   1/2 HP      | 1920   1/2 HP      |
| <b>SHIPPING DATA</b>                            |                    |                    |
| Length - Crated in.                             | 72 (182.9 cm)      | 84 (213.4 cm)      |
| Width - Crated in.                              | 42 (106.7 cm)      | 42 (106.7 cm)      |
| Height - Crated in.                             | 35 (88.9 cm)       | 42 (106.7 cm)      |
| Volume - Crated cu. ft.                         | 61 (1727.3 l)      | 86 (2435 l)        |
| Weight - Crated lbs.                            | 435 (197 kg)       | 558 (253 kg)       |

### NOTES:

1. Height as measured without optional stainless steel work top.
2. MDEC= Maximum Daily Energy Consumption
3. Based on a 90°F ambient and 20°F evaporator.

## EQUIPMENT SPECIFICATIONS

### CONSTRUCTION, HARDWARE, INSULATION

Cabinet exterior front, sides, louver assembly and drawers are constructed of heavy gauge stainless steel, exterior back and bottom are constructed of heavy gauge galvanized steel. Cabinet interior sides, top and bottom are constructed of heavy gauge stainless steel. A set of 4" high casters are included standard. Both the cabinet and drawers are insulated with an average of 2" thick high density, non-CFC foamed in place polyurethane.

### SELF-CONTAINED REFRIGERATION SYSTEM

The left side mounted, self-contained, balanced refrigeration system using environmentally friendly, non-flammable R-448A refrigerant features a hot gas defrost, capillary tube, air-cooled hermetic compressor, automatic condensate evaporator, and a dedicated rear-mounted evaporator design which distributes cold air through each drawer section. A 9' cord and retainer is provided. Standard operating temperature is -5° to 0°F (-20° to -17°C).

### CONTROL

The easy to use water resistant microprocessor control is supplied standard. It includes a 3-Digit LED Display, and a Fahrenheit or Celsius Temperature Scale Display Capability.

### DRAWERS

Each heavy-duty drawer is designed to accommodate 12" x 20" x 6" deep pans. They are constructed using heavy gauge stainless steel drawer slides and 2" diameter stainless steel rollers. Drawers include both a self-closing and stay-open feature.

### WARRANTY

Both a three year parts and labor warranty and a five year compressor warranty (self-contained models only) are provided standard.

When ordering please specify: Voltage, Hinging, Options and any additional warranties.

Equipped with one NEMA 5-15P Plug



CONTINUED PRODUCT DEVELOPMENT MAY NECESSITATE SPECIFICATION CHANGES WITHOUT NOTICE.